

GENERAL NOTES

- THESE DRAWINGS SHALL NOT BE SCALED.
- THE CONTRACTOR SHALL VISIT THE SITE AND SATISFY ONESELF ALL DIMENSIONS, DATUM AND DETAILED INFORMATION SHOWN ARE CORRECT.
- THE CONTRACTOR IS TO REVIEW AND COORDINATE ALL STRUCTURAL, MECHANICAL AND ELECTRICAL DRAWINGS FOR ADDITIONAL OPENINGS THROUGH FLOORS, WALLS, AND CEILINGS FOR DUCT, PIPE & ELECTRICAL RISERS AND ALL OPENINGS NOT SHOWN ON DRAWINGS.
- ALL PRODUCTS AND MATERIALS TO BE USED AND INSTALLED SHALL CONFORM WITH MANUFACTURER'S SPECIFICATIONS & APPLICABLE CODES.

LEGEND:

INSTALL ICE & WATER SHIELD MEMBRANE EXTENDING A MINIMUM OF 3'-0" UPSLOPE FROM THE INTERSECTION OF THE DORMER & GABLE ROOF

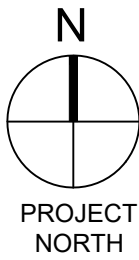

1 FLOOR PLAN
1/4" = 1' - 0"

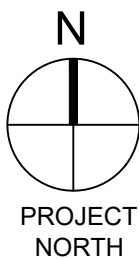

3 PARTIAL FLOOR PLAN @ HIGH LEVEL
1/4" = 1' - 0"

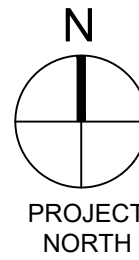

2 ROOF PLAN
1/4" = 1' - 0"

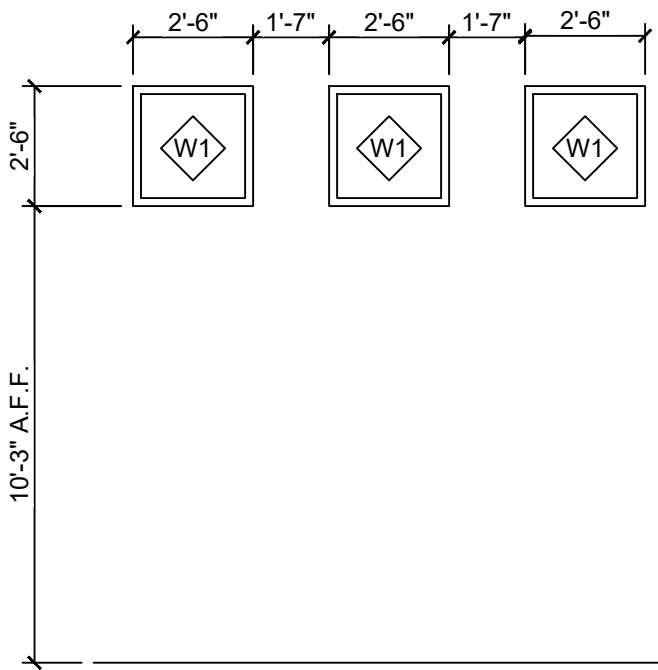

WINDOW ELEVATIONS:

DOOR HARDWARE:

DOOR D100
HOLLOW METAL INSULATED DOOR IN PRESSED STEEL FRAME - PAINT FINISH
3 HINGES: CB91 114x 101 NRP 26D CST
1 DEADBOLT: B660P 50-210-MK 626 CSC
1 PASSAGE SET: AL10S SAT 626 CSC
1 CRASH STOP: CS115-25 US26D CIV
1 ASTRAGAL: W-7 2134 PRIMED CKN
1 THRESHOLD: CT-11 900 AL CKN
1 DOOR CLOSER: LCN 4040XP 689

DOOR D100A
DOOR & MISC. HARDWARE BY DOOR SUPPLIER

OVERHEAD DOOR TO BE:
• MODEL 9405 - CARRIAGE HOUSE STEEL
• WESTFIELD STYLE
• COLOUR: PRE-FINISHED WHITE

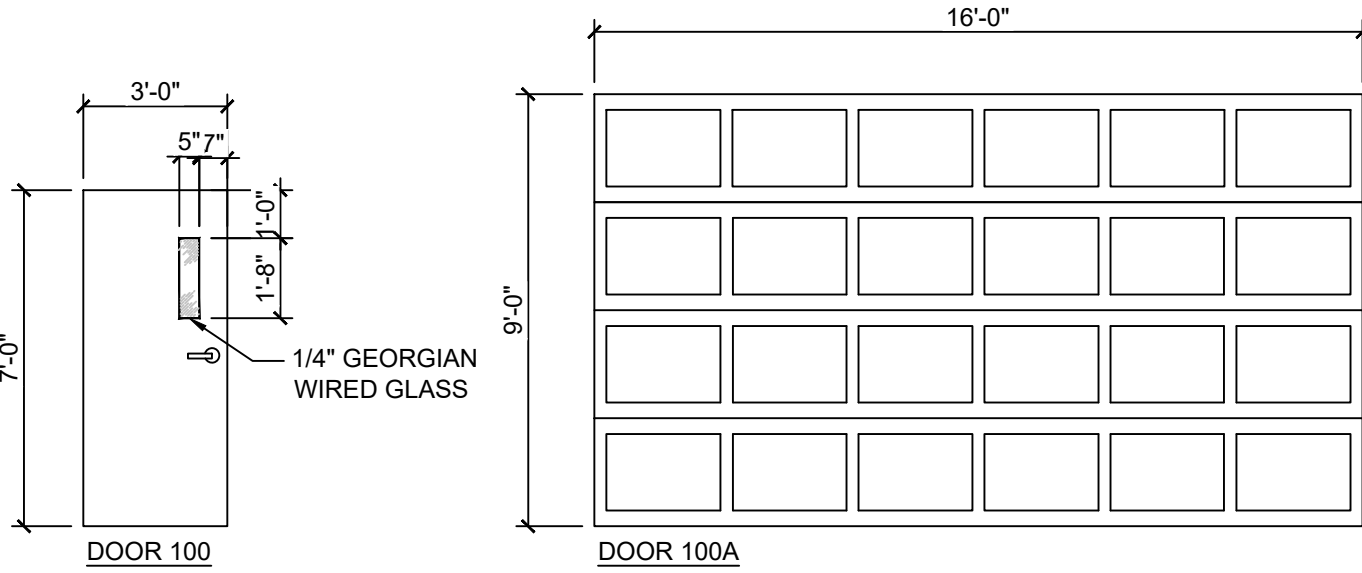

DOOR ELEVATIONS:

WALL SCHEDULE:	
(P1)	UNINSULATED EXTERIOR WALL: <ul style="list-style-type: none">3/4" PLYWOOD TO 8'-6" ABOVE CONCRETE FLOOR, LEAVE 6" GAP AT BASE OF WALL2x6 WOOD STUDS @ 16" O/C C/W PRESSURE TREATED SILL PLATES5/8" PLYWOOD SHEATHINGBUILDING WRAPFIBRE CEMENT SIDING (REFER TO ELEVATIONS FOR SIDING TYPES)
(P2)	UNINSULATED EXTERIOR WALL: <ul style="list-style-type: none">3/4" PLYWOOD TO 8'-6" ABOVE CONCRETE FLOOR, LEAVE 6" GAP AT BASE OF WALL2x12 WOOD STUDS @ 16" O/C C/W PRESSURE TREATED SILL PLATES5/8" PLYWOOD SHEATHINGBUILDING WRAPFIBRE CEMENT SIDING (REFER TO ELEVATIONS FOR SIDING TYPES)

ROOF SCHEDULE:	
(R1)	GARAGE ROOF CONSTRUCTION: <ul style="list-style-type: none">30 YEAR ASPHALT SHINGLESSYNTHETIC UNDERLAYMENT5/8" PLYWOOD BOARD W/ H-CLIPSPRE-ENGINEERED TRUSS SYSTEM @ 24" O.C. (REFER TO STRUCTURAL FOR DETAILS)
(R2)	DORMER ROOF CONSTRUCTION: <ul style="list-style-type: none">30 YEAR ASPHALT SHINGLESSYNTHETIC UNDERLAYMENTICE & WATER SHIELD TO COVER ENTIRE DORMER ROOF5/8" PLYWOOD BOARD W/ H-CLIPSPRE-ENGINEERED TRUSS SYSTEM @ 24" O.C. (REFER TO STRUCTURAL FOR DETAILS)

No.	REVISION/DESCRIPTION	BY	DATE
01	ADDENDUM #1	HA	07.14.2025
00	ISSUED FOR CONSTRUCTION	HA	05.01.2025

SEAL

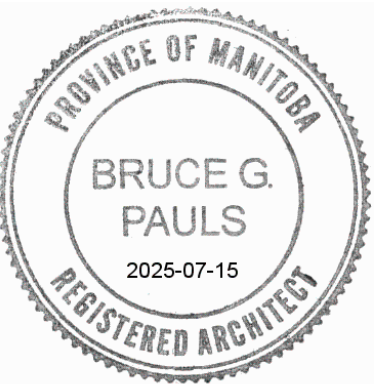

DATE	DESIGN	DRAWN	CHECKED	APPROVED
2025.05.01	BY: HA	BY: HA	BY: BP	BY: BP



PROJECT
PARKS & OPEN SPACE DIVISION
BUNN'S CREEK PARK - STORAGE GARAGE

365 McIVOR

SHEET TITLE
FLOOR PLAN
ROOF PLAN
SCHEDULES

SCALE	PROJECT No:	SHEET No:
AS SHOWN	2023-049	A1-R1